

Thermboil E

New concept in thermodynamic compact system.

Hot water up to 55°C available 24h per day.

The THERMBOIL E Serie is an innovative water heater that include a heat pump system with solar gain and a water tank.

This system is able to capture the ambient solar energy to heat water efficiently, with very low consumption compared to conventional systems.

This system reaches an energy performance up to 20% higher than traditional solar thermal systems on the market.

Also available at 60°C (GH version)



DOMESTIC HOT WATER



ECONOMIC



EASY INSTALLATION



WORKS 24H DAY & NIGHT



LOW CONSUMPTION



LOW NOISE LEVEL



Thermodynamic panel

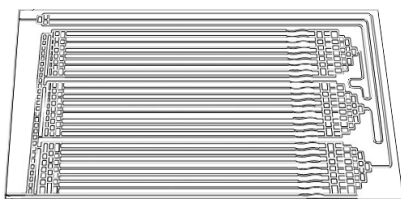

80%

Savings

25

Years of useful life

6,2 kg

Low weight

Technical specifications

Model		Thermboil 75 E	Thermboil 110 E	Thermboil 130 E	Thermboil 180 E	Thermboil 200 E	Thermboil 250 E	Thermboil 300 E	Thermboil 500 E
Formato		Mural/Suelo	Mural/Suelo	Mural/Suelo	Suelo	Suelo	Suelo	Suelo	Suelo
Material		Inox	Inox	Inox	Inox	Inox	Inox	Inox	Inox
Presión máxima de servicio	bar	6	6	6	6	6	6	6	6
Capacidad	l	75	110	130	180	200	250	300	500
Temperatura max modo bomba de calor	°C	55	55	55	55	55	55	55	55
Temperatura máxima apoyo eléctrico	°C	70	70	70	70	70	70	70	70
Temperatura air mín/máx	°C	-5/42	-5/42	-5/42	-5/42	-5/42	-5/42	-5/42	-5/42
Nominal power range Acs	W	1600-2200	1600-2200	1600-2200	1600-2200	1600-2200	1600-2200	1600-2200	3200-4400
Rango consumo nominal	W	400-600	400-600	400-600	400-600	400-600	400-600	400-600	800-1200
COP		2-5	2-5	2-5	2-5	2-5	2-5	2-5	2-5
Potencia térmica del sistema de apoyo	W	1500	1500	1500	1500	1500	1500	1500	3000
Potencia térmica máxima con apoyo	W	3700	3700	3700	3700	3700	3700	3700	7400
Consumo máximo con apoyo eléctrico	W	2100	2100	2100	2100	2100	2100	2100	4200
Power supply	V/ph/Hz	230/1/50	230/1/50	230/1/50	230/1/50	230/1/50	230/1/50	230/1/50	230/1/50
Conexiones hidráulicas*	"	H* 3/4-3/4	H* 3/4-3/4	H* 3/4-3/4	H* 3/4-3/4	M* 3/4-3/4	M* 3/4-3/4	M* 3/4-3/4	M* 1-1
Salida de condensados	"	1/2	1/2	1/2	1/2	1/2	1/2	1/2	1/2
Insulation type	-	Poliuretano inyectado	Poliuretano inyectado	Poliuretano inyectado	Poliuretano inyectado	Poliuretano inyectado	Poliuretano inyectado	Poliuretano inyectado	Poliuretano inyectado
Transmisión de calor medio	W/m²°C	0.025	0.025	0.025	0.025	0.025	0.025	0.025	0.025
Espesor medio del aislamiento	mm	50	50	50	50	50	50	50	50
Dimensions (AxBxC)***	mm	1000 x 450 x 495	1170 x 450 x 495	1405 x 450 x 495	1920 x 450 x 495	1452 x 601 x 550	1760 x 601 x 550	2008 x 601 x 550	2008 x 710 x 743
Auxiliary dimensions (DxExF)**	mm	140 x 510 x 685	140 x 760 x 935	140 x 1000 x 1135	140 x 1420 x 1555	140 x 960 x 1115	140 x 1270 x 1425	140 x 1515 x 1665	170 x 1510 x 1695
Panel dimensions termodinámico (AxBxC)**	mm	1700 x 800 x 25	1700 x 800 x 25	1700 x 800 x 25	1700 x 800 x 25	1700 x 800 x 25	1700 x 800 x 25	1700 x 800 x 25	1700 x 800 x 25
Presión máxima del panel	bar	10	10	10	10	10	10	10	10
Conexiones panel termodinámico****	"	1/4 - 3/8	1/4 - 3/8	1/4 - 3/8	1/4 - 3/8	1/4 - 3/8	1/4 - 3/8	1/4 - 3/8	1/4 - 3/8
Conexiones Thermboil***	"	1/4-3/8	1/4-3/8	1/4-3/8	1/4-3/8	1/4-3/8	1/4-3/8	1/4-3/8	1/4-3/8
Peso panel termodinámico	kg	6.2	6.2	6.2	6.2	6.2	6.2	6.2	6.2
Peso en vacío del equipo	kg	72	72	90	93	92	105	114	180
Nº Paneles		1	1	1	1	1	1	1	2
Sound power****	dBA	<35	<35	<35	<35	<35	<35	<35	<35
Clase de protección		IP21	IP21	IP21	IP21	IP21	IP21	IP21	IP21
Refrigerant		R134A	R134A	R134A	R134A	R134A	R134A	R134A	R134A
Ciclo de extracción		M**	M**	L**	L**	L**	XL**	XL**	XXL**
Clase energética		A	A	A	A	A	A	A	A

M*(Input and output of the male hydraulic connection)
H*(Input and output of the female hydraulic connection)
**Dimensions (A= height B=width C=deep)
***Inlet/Outlet (roscar SAE)
****Sound power at 2 meters distance

Views

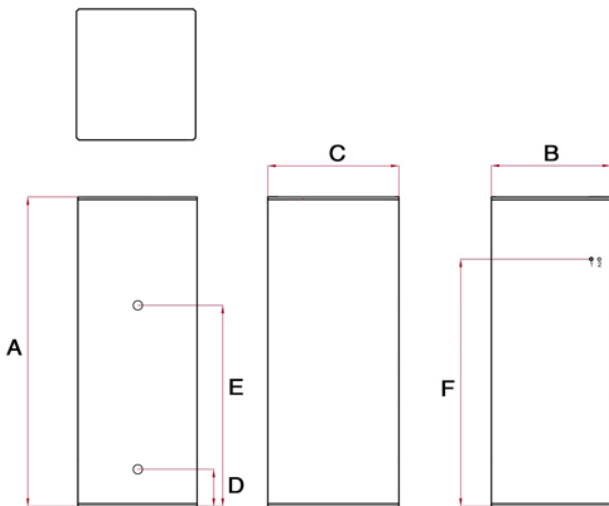

Advantages

- Sheathed immersion heater ✓
- Protection against corrosion by titanium anode ✓
- Security valve ✓
- Digital temperature controller ✓
- Alarm indicators ✓

Optional

- Coils**
Solar (1.2 m2) | Boiler (0.6 m2) | Double (1.2 + 0.6 m2)
- Anti-legionella / Internal timer**
Weekly programming to increase temperature through the immersion once a week

Other models

| 75 | 110 | 130 | 180 | 200 | 250 | 300 | 500

Certifications



www.energypanel.net - contacto@energypanel.net

Technical data generated exclusively for informational purposes. The specifications are subject to alterations without prior notice.